

Property introduction by

Chris De Kock

078 463 0442 | chris@factoryspace.co.za

081 756 8554 

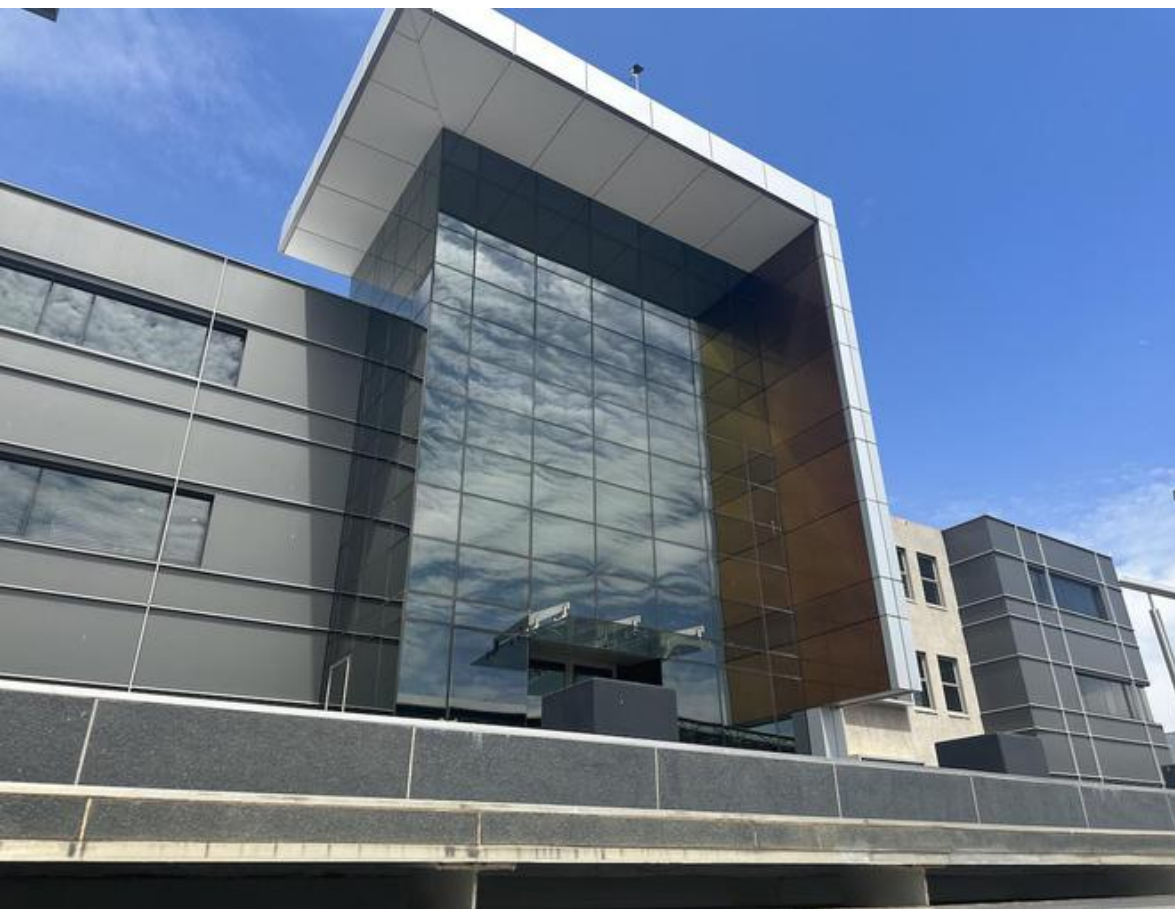

346 SQM AAA-GRADE OFFICE TO LET AT 263 A WEST AVE....

WEB REF CL5387

Floor Size 346 m²

Rental (per m²) R125

Asking Rental R44750

Factory/Warehouse -

Office Size 358 m²

Yard Size -

Availability Immediately

Building Height (m) -

Power (Amps) -

Reduced rentals and Smartmove offered on deals of 3 years or more.
(T&C's apply / Valid until end Dec 2023)!!!

Discover Your Ideal Workspace in Centurion's Prime Location

Extras

24 Hour Security

Access Control

Legal: *The client hereby agrees that the above property has been introduced by Factory Space (Pty) Ltd to the Client. The Client further confirms that they mandated Factory Space (Pty) Ltd to find and present suitable premises to them.*

.....
For The Client

.....
As Witness

.....
Date